



SINOCERA



Global Sensor Technology

Piezoelectric Velocity Transducer (4-20mA output)

Model: CS-YD-012

FEATURES

- Built-in piezoelectric accelerometer and for converting acceleration to velocity output by internal precise integrating circuit.
- Wide frequency response, high sensitivity.
- 4-20mA output.

SUPPLIED WITH

Calibration chart
2-core shielded cable (3m)



Technical Specifications:

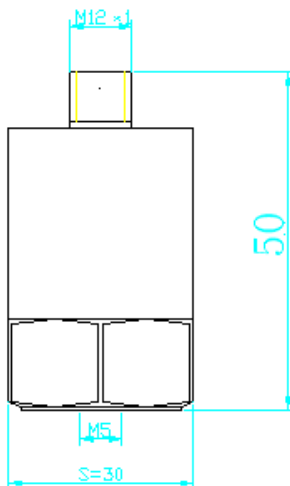

Measuring Range	0-100mm/s
Output	4-20mA
Frequency Range	10 to 2000Hz
Transverse sensitivity	<5%
Operating Temperature Range	-10 °C to +70 °C
Power Supply	+24VDC
Case Material	Stainless Steel
Weight	100g
Mounting	M5
Sensing Element	PZT-5
Output Type	2-pins Socket Pin 1: VCC+ ; Pin 2: Signal Output Case: Ground

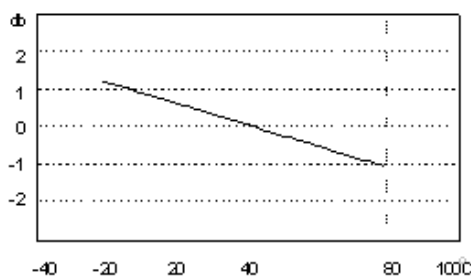

Typical Temperature Curve

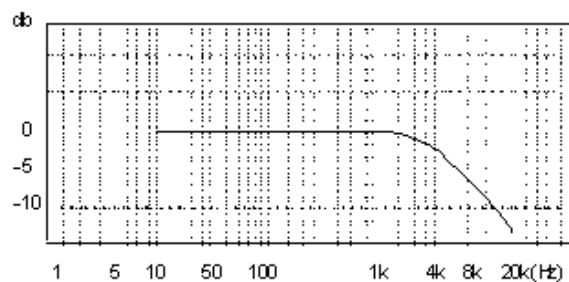

Typical Frequency Response Curve

Global Sensor Technology

Unit 1, 26 Fairholme Road, Manchester, M20 4NT, UK

Phone: +44 (0)161 446 4848 Fax: +44 (0)161 438 2828 www.globalsensortech.com techsupport@globalsensortech.com