



SINOCERA



Global Sensor Technology

# 1Hz to 5kHz 10mV/ms<sup>-2</sup> ICPE Accelerometer

# Model CA-YD-186

### FEATURES

- Internal ICPE circuit
- Low output impedance
- Connection with standard cable
- Simple measurement system

### SUPPLIED WITH

- Calibration chart
- M5 stud
- Protective cap
- STYV-1 cable fitted with L5 connectors(2metres)

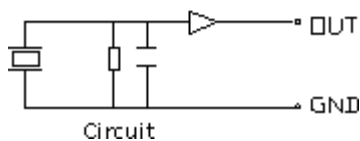
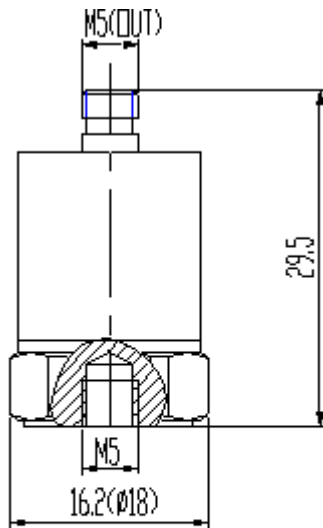

### PERFORMANCE

Sensitivity (20±5°C)	10mV/ms <sup>-2</sup>
Measurement range	500ms <sup>-2</sup>
Transverse sensitivity	≤5%
Frequency response	see graph below
Frequency range (10%)	1Hz to 5kHz
Resonant frequency	25kHz
Temperature response	see graph below
Output phase	in phase with input

### ELECTRICAL CHARACTERISTICS

Supply voltage	12V to 28V(DC)
Operating current	2mA to 10mA
Maximum output (peak)	5V
Output impedance	<100Ω
Noise (1 ~ 20 kHz)	<0.4mg
DC offset	7±1V

### ENVIRONMENTAL CHARACTERISTICS

Temperature range	-20°C to 120°C
Shock limit	10,000ms <sup>-2</sup>
Thermal transient sensitivity	0.08ms <sup>-2</sup> /°C(3Hz)
Magnetic sensitivity	15ms <sup>-2</sup> /T
Base strain sensitivity	2×10 <sup>-3</sup> ms <sup>-2</sup> /µε

### PHYSICAL CHARACTERISTICS

Weight	35g
Case material	stainless steel
Mounting	M5 thread
Sensing element	PZT-5
Sensing method	shear
Output connection	L5 top connector

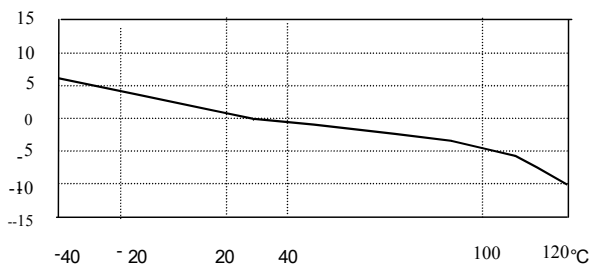

Typical Temperature Response

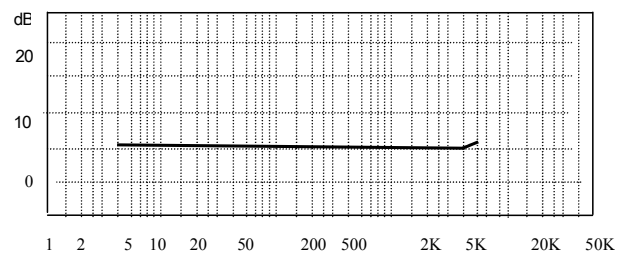

Typical Frequency Response (Hz)

Global Sensor Technology

Unit 1, 26 Fairholme Road, Manchester, M20 4NT, UK

Phone: +44 (0)161 446 4848 Fax: +44 (0)161 438 2828 [www.globalsensortech.com](http://www.globalsensortech.com) techsupport@globalsensortech.com