



SINOCERA



Global Sensor Technology

Condition Monitoring Accelerometer

Model: CA-YD-169

FEATURES

- General purpose vibration and shock measurement
- Low cost
- TO-8 type case
- Charge output

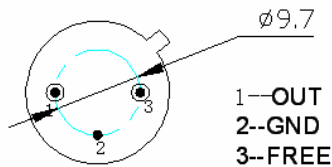
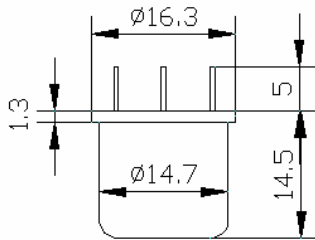

PERFORMANCE

Sensitivity (at 20±5°C)	12pC/ms ²
Transverse sensitivity	≤5%
Measurement range	250 ms ⁻²
Frequency response	see graph below
Frequency range	1 - 8000Hz (3dB)
Mounted resonance	>15kHz
Temperature response	see graph below
Output phase	in phase with input
Isolation resistance	>10 ⁹ Ω
Capacitance	~4600pF

PHYSICAL CHARACTERISTICS

Weight	24g
Case material	stainless steel
Mounting	Adhesive or Jig
Sensing element	PZT-5
Sensor design	Shear
Electrical connection	0.5mm pin

ENVIRONMENTAL CHARACTERISTICS

Temperature range	-40°C to +120°C
Shock limit	50,000ms ⁻² (5000g)
Thermal transient sensitivity	0.008ms ⁻² /°C
Magnetic sensitivity	15ms ⁻² /T
Base strain sensitivity	2×10 ⁻³ ms ⁻² /με

2-Wire Charge Mode

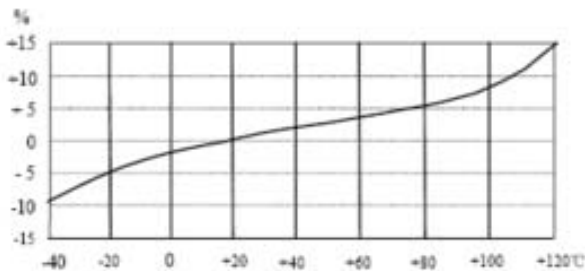
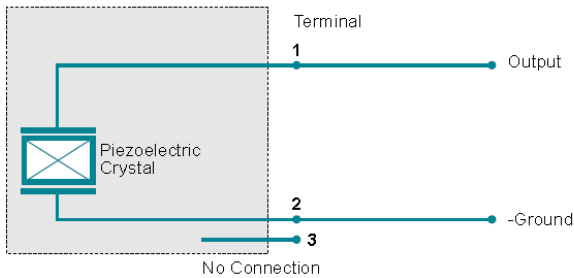

Typical Temperature Response

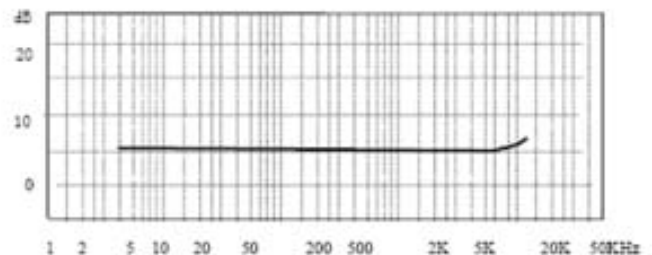

Typical Frequency Response

Global Sensor Technology

Unit 1, 26 Fairholme Road, Manchester, M20 4NT, UK

Phone: +44 (0)161 446 4848 Fax: +44 (0)161 438 2828 www.globalsensortech.com techsupport@globalsensortech.com