

FEATURES

- Differential capacitance working principle
- Wide frequency range from DC to 500Hz
- Tri-axial output (X, Y, Z)

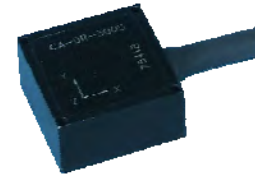

SPECIFICATIONS

Sensitivity (at 20°±5C)	25±10% mV/ m/s ² (X, Y, Z)
Measurement Range	±10 m/s ²
Transverse Sensitivity	≤5 %
Non-linearity	≤0.5%
Frequency Range	DC to 500 Hz
Mounted Resonance	5,500Hz
Temperature Range Frequency	-40 to +85 °C
Temperature Sensitivity	0.1 mV/°C
Shock limit (No Supply)	±5000 m/s ²
Power Supply	+6 to +16 VDC
Operating Current	≤3mA
Offset Voltage	2.5±0.1VDC
Noise(100Hz)	< 2.25mVrms
Output impedance	< 100 Ω
Weight	30 g
Case material	Aluminum- Alloy
Mounting	4-Φ2.5 hole
Output Cable	2m integral 5 core cable: Red: Power Supply; White: Ground; Yellow: X-axial output; Blue: Y-axial output; Green: Z-axial output
Accessories	
Calibration Chart	1
M2.5×20 Screw	4

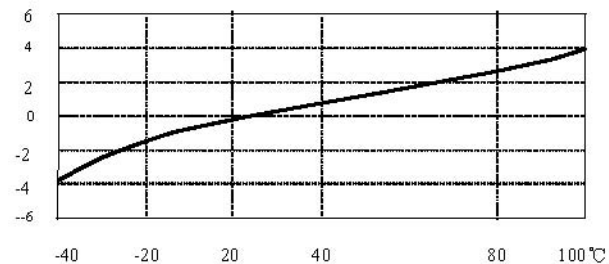
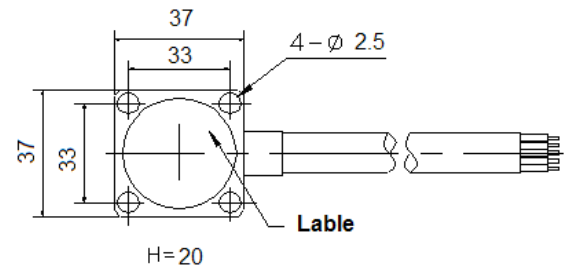

Typical Temperature response

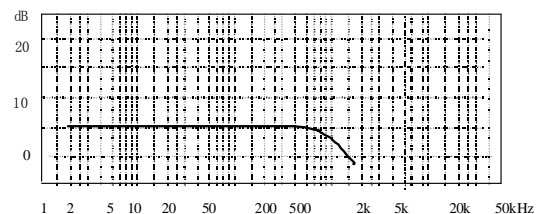

Typical Frequency response